

Thermal bridges are often created wherever components are mechanically fastened on the outside of a building (for example, rainscreen facade, curtainwall, canopy, etc.). Those thermal bridges then unnecessarily release valuable heating energy (or cooling energy) during operation of the building. A lot of energy every year! Lost!

This is not good for three reasons:

1. Cost of energy bill (*money*)
2. Poor carbon footprint of building (*bad for environment*)
3. Risk of mold and mildew (*unhealthy*)

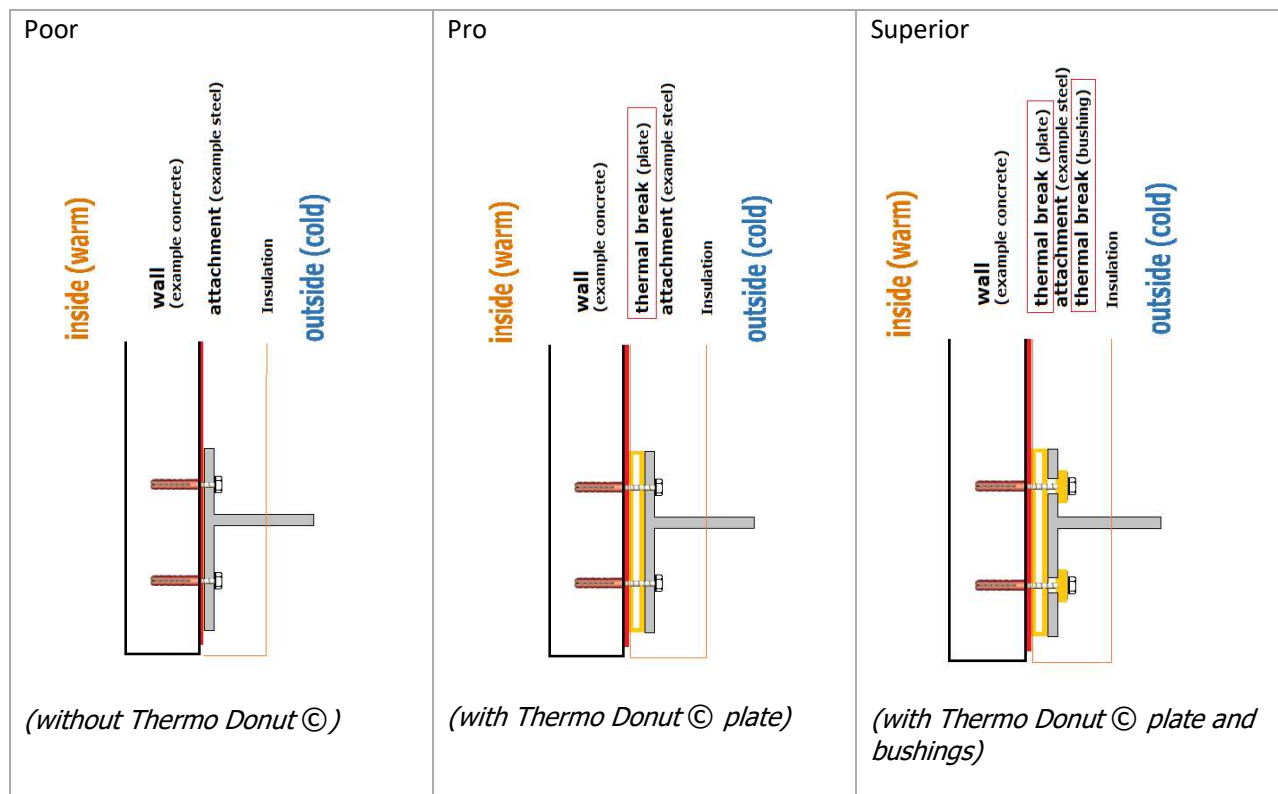

Thermo Donut © System stops this! The thermal breaks interrupt the thermal bridges and thus prevent uncontrolled flow of valuable energy.